

Installation process

Compared to the previous version, new Fylo modules maintain its aesthetic unchanged. When fully installed, profiles disappear by merging with the surrounding architecture; integrated light concept allows space customization with unusual and precious lighting details.

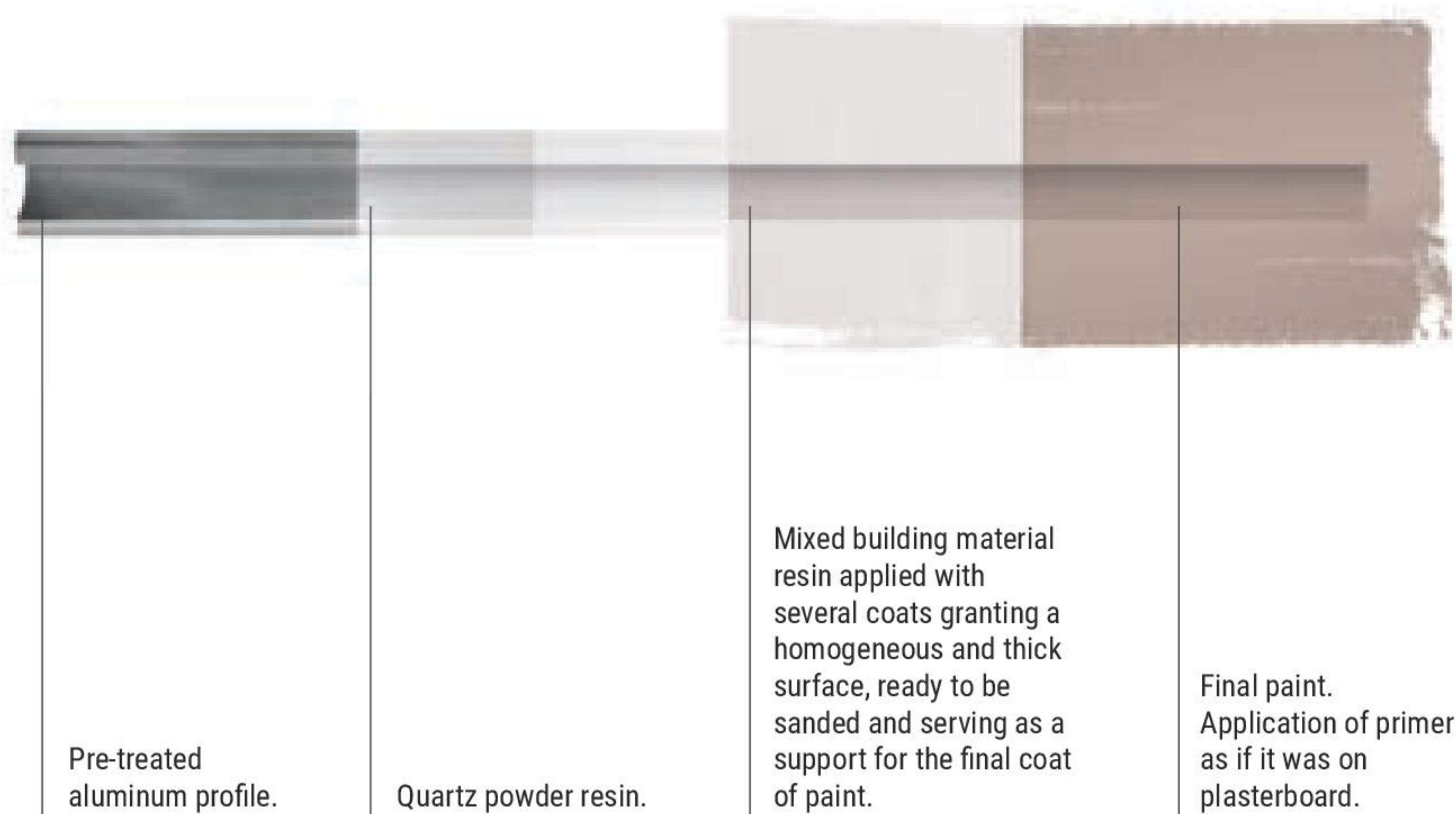

Full integration in the masonry

Its high resistance to weathering allows Fylo+ outdoor to be installed in complete safety. It provides high reliability thanks to its materials and build quality.

1. Make recess in masonry wall.
2. Insert EPS outer casing.
3. Block EPS outer casing into place using cement-based plaster.
4. Remove outer casing and prepare power supply cable.
5. Insert profile in the seat previously created.
6. Complete installation applying several coats of plaster making sure that mesh tape adheres on first coat. Carry out the electrical connection and insert the LED source.

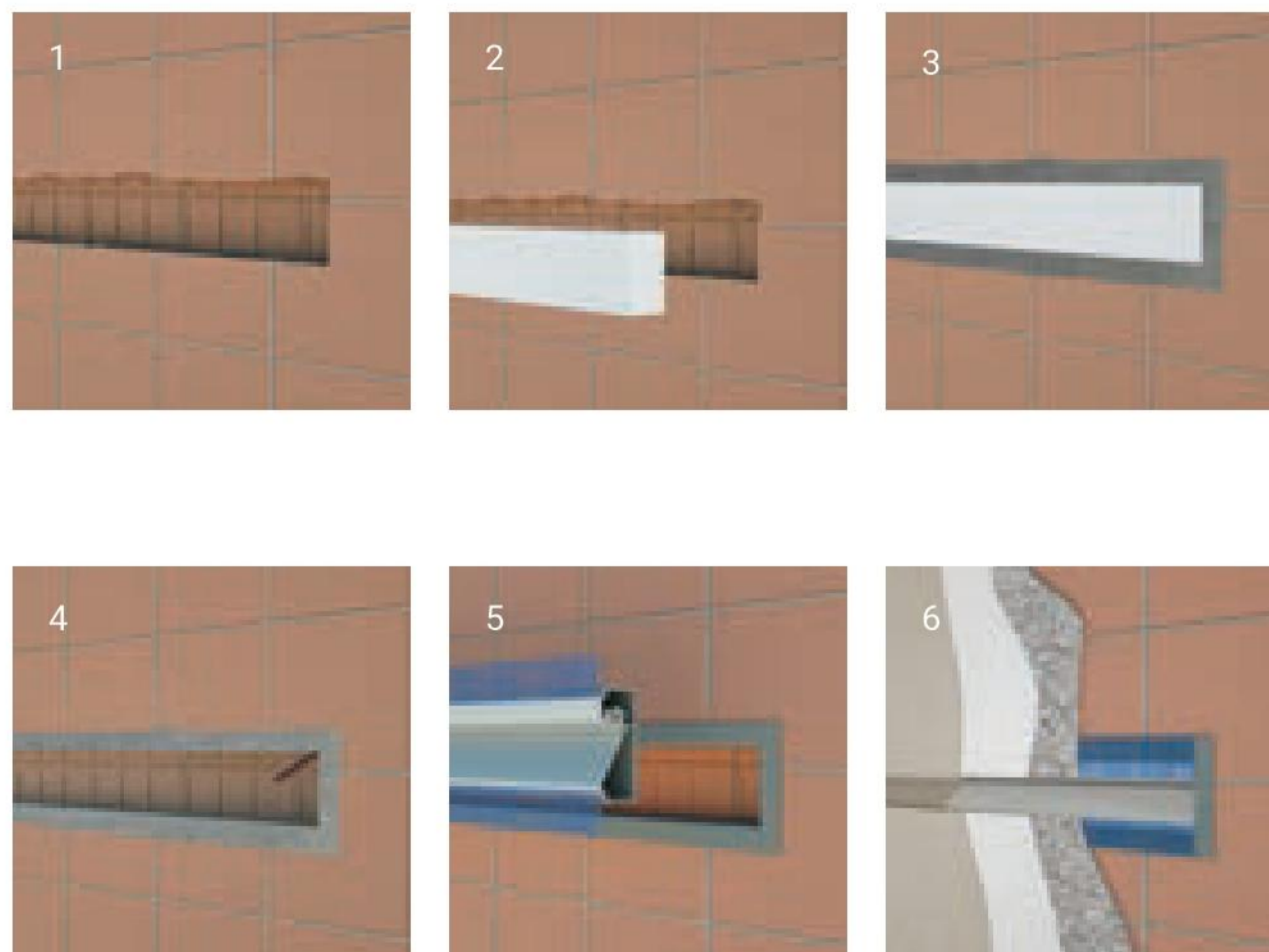

Full integration in the insulation system

1. Cut external wall insulation in order to create profile seat..
2. Pass power supply cables, apply polyurethane adhesive on profile rear side and insert it in seat. Install end caps if necessary.
3. Apply adhesive first coat. Position mesh tape with the sole exception of the profile part in relief. Apply the other adhesive coats and then plaster.
4. After completing all required operations, insert LED source in the relevant optical compartment and carry out electrical connections.

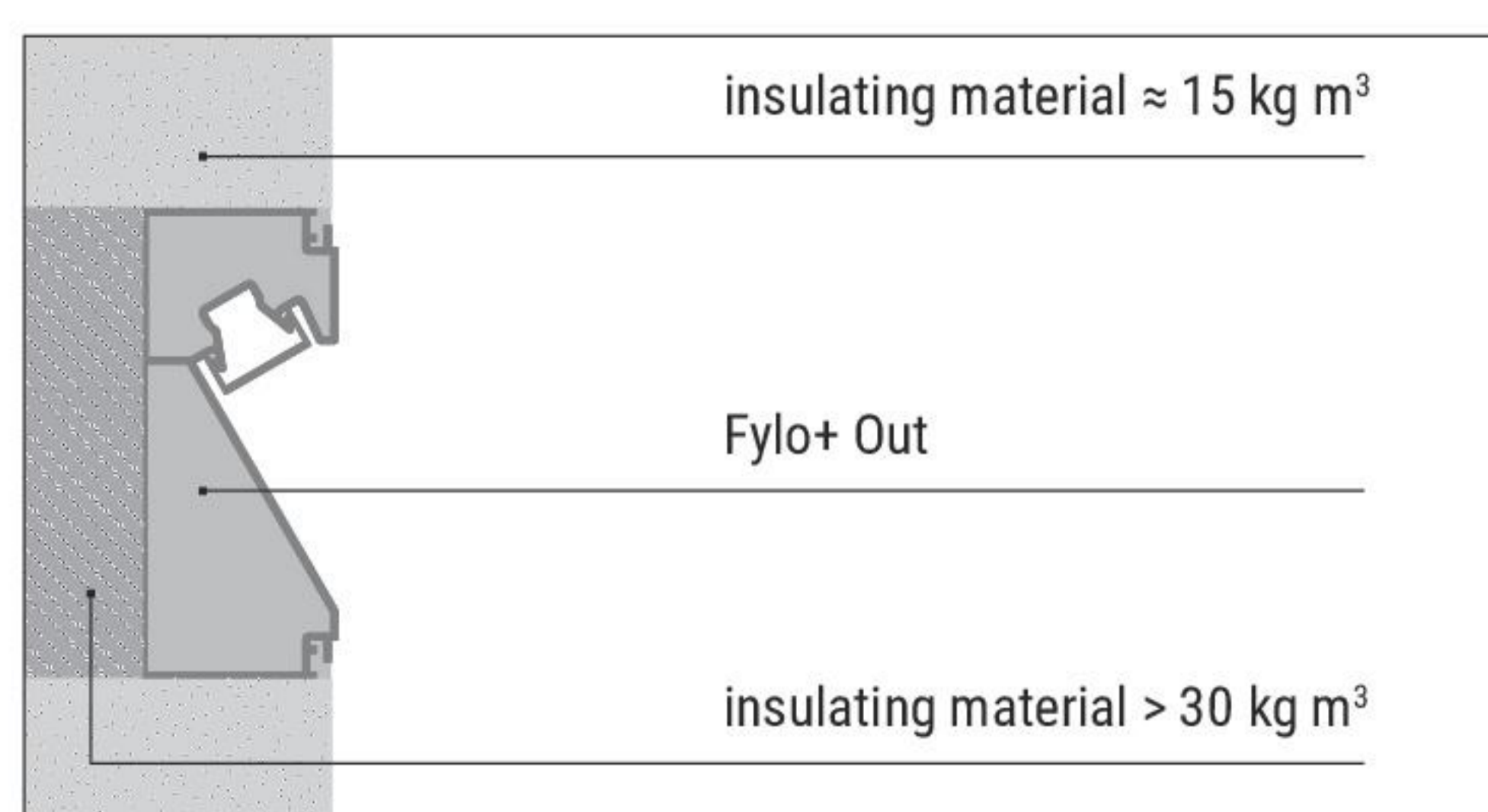

* It is advisable to opt for an insulating material with density at least twice greater than the one used for the cladding as the support surface for Fylo, so as to increase thermal insulation.