

F.

Kos

IP65 IK07

WALL EFFECT LIGHT
Comfort concentrated reflector



Collection name

KOS

KOS

KOS

KOS

Technical data

Power (Real data)	9.5 W	9.5 W	2 x 9.5 W	2 x 9.5 W
Lumen 3000K (Real data)	157 lm (Optic .00)	157 lm (Optic .00)	2 x 157 lm (Optic .00)	2 x 157 lm (Optic .00)
Lumen 4000K (Real data)	161 lm (Optic .00)	161 lm (Optic .00)	2 x 161 lm (Optic .00)	2 x 161 lm (Optic .00)
Class	I	I	I	I
Nominal Voltage	220-240V 50/60Hz	220-240V 50/60Hz	220-240V 50/60Hz	220-240V 50/60Hz
Power supply	Included	Included	Included	Included
Openings	Single emission	Single emission	Double emission	Double emission

Configuration code

Select finish / led / optic

30501 + X + Y + Z

30524 + X + Y + Z

30503 + X + Y + Z

30526 + X + Y + Z

Finish **X**

- 1 - Anthracite gloss 8-10
- 2 - White (RAL 9010)
- 4 - Grey (RAL 9006)
- 8 - Dark brown

- 1 - Anthracite gloss 8-10
- 2 - White (RAL 9010)
- 4 - Grey (RAL 9006)
- 8 - Dark brown

- 1 - Anthracite gloss 8-10
- 2 - White (RAL 9010)
- 4 - Grey (RAL 9006)
- 8 - Dark brown

- 1 - Anthracite gloss 8-10
- 2 - White (RAL 9010)
- 4 - Grey (RAL 9006)
- 8 - Dark brown

Color LED **Y**

- .2 - 2700K CRI > 80
- .3 - 3000K CRI > 80
- .4 - 4000K CRI > 80

- .2 - 2700K CRI > 80
- .3 - 3000K CRI > 80
- .4 - 4000K CRI > 80

- .2 - 2700K CRI > 80
- .3 - 3000K CRI > 80
- .4 - 4000K CRI > 80

- .2 - 2700K CRI > 80
- .3 - 3000K CRI > 80
- .4 - 4000K CRI > 80

Optic **Z**

- .00 - 3° Spot
- .01 - 10° Spot
- .36 - 25° Medium
- .37 - 20°x115° Elliptical
- .34 - 65° Wide
- .06 - Asymmetric

- .00 - 3° Spot
- .01 - 10° Spot
- .36 - 25° Medium
- .37 - 20°x115° Elliptical
- .34 - 65° Wide
- .06 - Asymmetric

- .00 - 3° Spot
- .01 - 10° Spot
- .36 - 25° Medium
- .37 - 20°x115° Elliptical
- .34 - 65° Wide
- .06 - Asymmetric

- .00 - 3° Spot
- .01 - 10° Spot
- .36 - 25° Medium
- .37 - 20°x115° Elliptical
- .34 - 65° Wide
- .06 - Asymmetric

Technical drawing

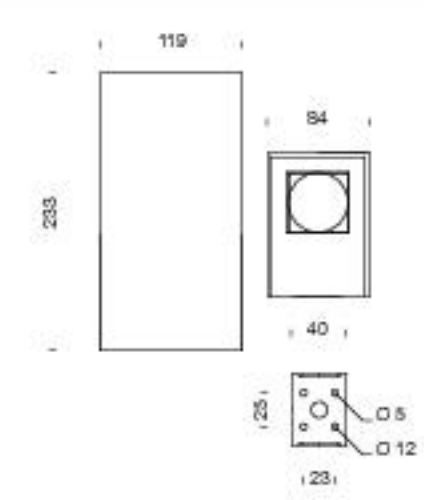
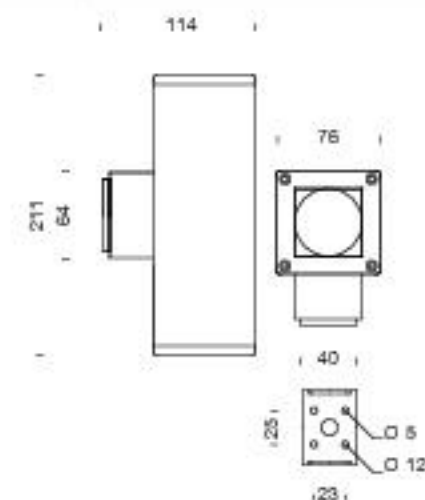
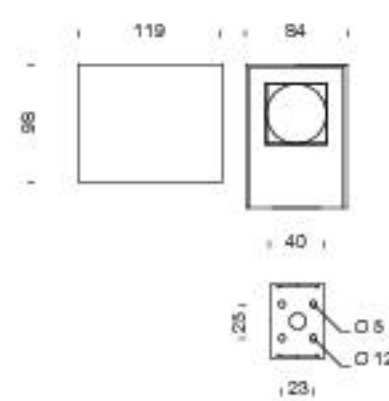
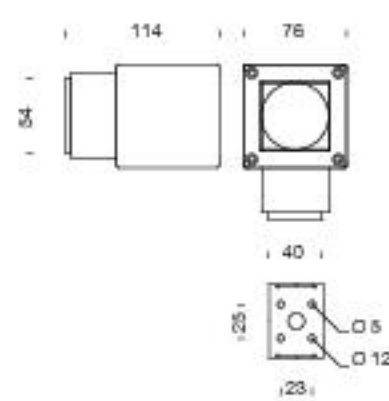

GU10 version available
on request