

mira 45 LT

LED

powered by
Seoul® Semiconductor Z5M

simmetrico
symmetric
symétriques
simétrico
symmetrisch

example code:
| art. | LED |  | anodized |
4157 LL2 H inx

art.
4157

design Ufficio Tecnico Landa



corpo alluminio estruso
anodizzato
body in extruded
aluminium
corps en aluminium extrudé
anodisé
cuerpo en aluminio
extrusionado y anodizado
Körper aus eloxiertem
fließgepresst Aluminium

diffusore policarbonato
trasparente
diffuser transparent
polycarbonate
diffuser polycarbonate
transparent
difusor policarbonato
transparente
Diffuser Polykarbonat klar

12 RECESSED



...brz



...inx

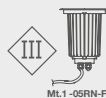
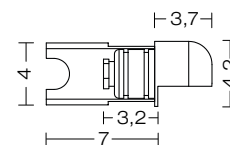
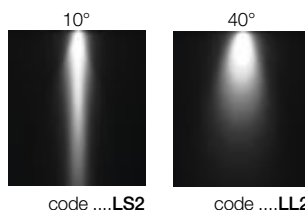

FOR TECHNICAL DETAILS VISIT
www.landa.it

IP66

art.	LUX 1mt	Beam	art.	LUX 1mt	Beam	W	V	Type	⊙ Ra
4157LS2N	1600	10°	4157LL2N	280	40°	2	24	4000K 160LM	80
4157LS2H	1600		4157LL2H	280				3000K 160LM	80



ELECTRIFICATION

LED

dettagli / details / details
détalles / details:
p.A54 - A55

Energy efficiency classes

Transformer available:

cod. 0409BT014 to connect up to **5** pieces – GE LIGHTING IP67 24V c.c. 12W
cod. 0409BT015 to connect up to **10** pieces – GE LIGHTING IP67 24V c.c. 25W

Transformer on request:

cod. 0409BT016 to connect up to **42** pieces – GE LIGHTING IP67 24V c.c. 100W

A++ ÷ A

Accessories on request:



code **0404M009**
Single connection IP68

mira 45 LT (24V)

Projectors

NEW

Recessed

Contemporary

Traditional



RECESSED

13



...brz



...inx

